

Accommodation Schedule	
168	168 Open Plan 1400X800 Desk
142	Flexible Seating
2	Office (2)
1	Meeting Room (10)
2	Meeting Room (6)
2	Meeting Room (4)
2	Phone Booth (2)
1	Teapoint
1	Comms Room
1	Store Room
3	Copy and Print Area
1	Reception

314 Total Working Positions
13723 sqft Total Area

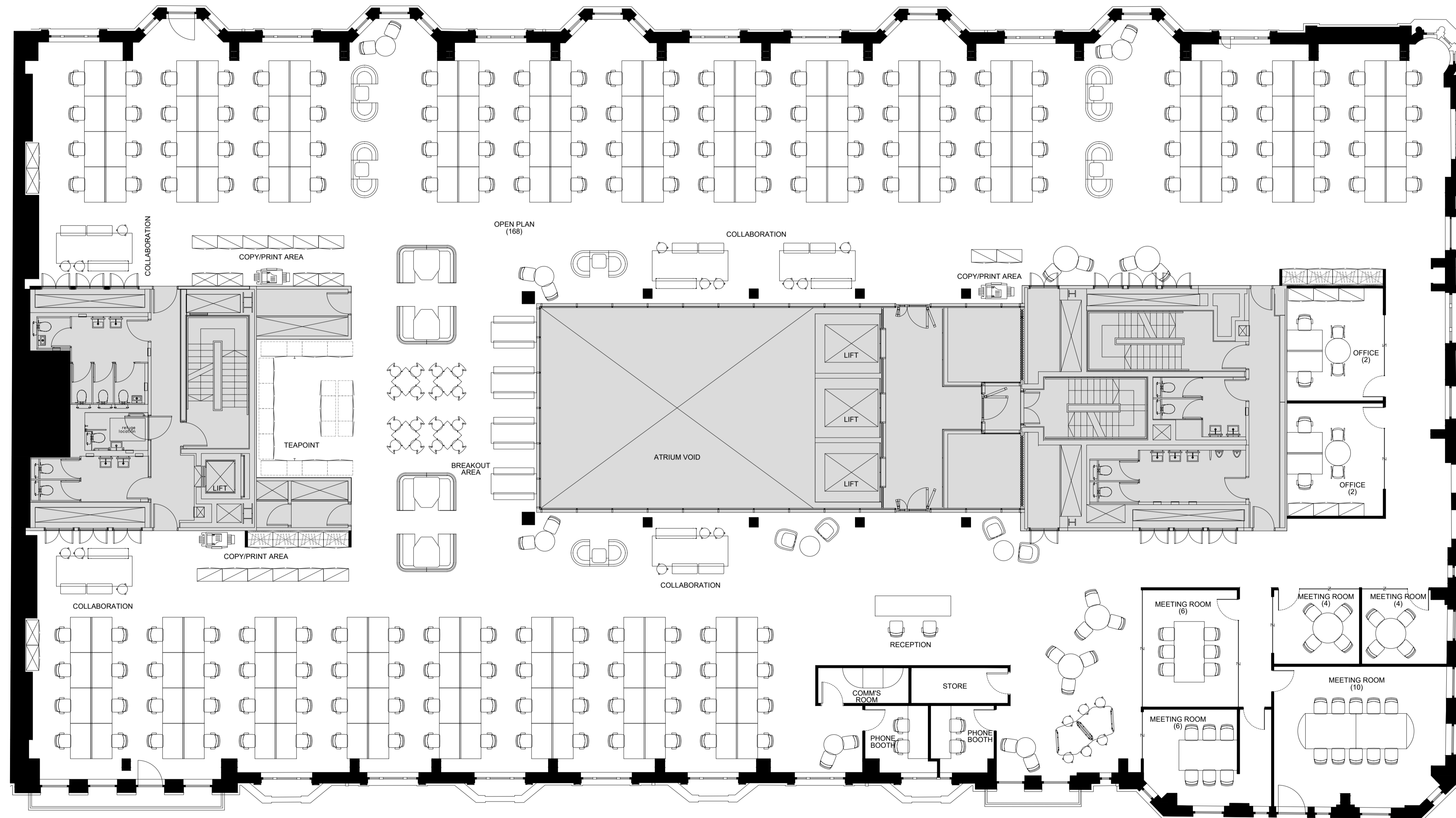

REV	DESCRIPTION	BY	DATE
-	Drawing first produced	RR/HW	14/01/2021

DRAWING STATUS
PRE CONSTRUCTION

160 Great Portland Street

Address
160 Great Portland Street
London
W1W 5QA

Project Number	Ref	Floor	Detail
-	01	04	GA

Drawing Title
Fourth Floor
General Arrangement (Design)

Produced by	Scale	Date Created	Rev
RR/HW	1:100@A1	14/01/2021	-

MARIS INTERIORS LLP
The Maris Building
65 Southwark Street
London SE1 0HR

T 020 7302 1866
E info@maris.co.uk
W maris.co.uk